



COR VISION SYSTEM

CORTIZO has designed more than 50 exclusive systems of windows, façades, composite panel, solar protection systems and balustrade. This commitment to innovation allows us to offer high value added products, maximizing energy efficiency, thermal and acoustic insulation and resistance to atmospheric agents.

COR VISION SYSTEM



Sliding system with Thermal Break of avant-garde design seeking maximum brightness with the minimum amount of seen aluminium interlock in the market (only 20 mm) and allows enclosing large openings of up to 13.2 (width) x 3 (height) metres in 6 sashes.

An elegance in design with the possibility of meetings at a 90° corner without mullions, achieving clear open spaces to enjoy the outside view.

- Transmittance U_w from 1,3 (W/m²K)*.
- Maximum acoustic insulation: $R_w = 41$ dB.

CATEGORIES ACHIEVED AT TEST CENTRE*

Air permeability	CLASS 4 (max)
Water tightness	CLASS 7A
Wind resistance	CLASS C5 (max)

OPENING POSSIBILITIES

Sliding of 2, 3, 4 & 6 sashes. Possibility of 3 rails & 1 rail: (1 sash+1 fixed light). Possibility of corner sash at 90° without mullions. Galandage: 1 & 2 sashes.

*CONSULT TYPOLOGY, DIMENSION AND GLASS.



RESISTANCE TO ATMOSPHERIC AGENTS [CORTIZO COMFORT]

All of CORTIZO's enclosing systems are tested in the Test Laboratory at the Technological Center to guarantee the best performance in watertightness, air permeability and wind loads, endorsed by the maximum results in its test qualifications.

THERMAL INSULATION [CORTIZO ENERGY EFFICIENCY]

Nowadays energy efficiency in buildings is a demand made, both by the architects, as by the final customer aware of the importance of saving on heating costs and air conditioner. CORTIZO meets such challenge with systems for every climatic area with a high insulation coefficient to ensure the comfort in the residence.

ACOUSTIC INSULATION [CORTIZO SILENCE]

In order to transform the residence into a private space, intimate and free of pollution outdoor acoustics, CORTIZO has designed its enclosing systems with all the latest technological developments necessary to ensure indoors peace and relax.

UNLIMITED COLOUR RANGE [CORTIZO COLOURS]

The whole RAL colour chart in powder coating, exclusive powder coating, metallic, textured, wood effect, more than 100 finishes in anodized. Aluminum on the outside and wood in the inside, two-coloured finishes... An unlimited offer to create a colour harmony at home. Quality labels in every process: QUALICOAT, SEA-SIDE, QUALIDECO and QUALANOD.

AVANT-GARDE AESTHETICS [CORTIZO DESIGN]

We create tailor-made windows and façades for every project. Creativity to answer aesthetically and functionally to each demand. Aesthetic answers to the technical needs. Creativity at the service of habitable environments.

ENCLOSURES FOR LIFE [CORTIZO DURABILITY]

Aluminum is the most durable, long-standing and resistant material of those used in enclosures. Aluminum has the strength and a durability of the things that last a whole lifetime.

SUSTAINABLE SPIRIT [CORTIZO SUSTAINABILITY]

Respect for the environment is CORTIZO'S commitment. Using innocuous raw materials and products in all our manufacturing process and the limitless possibility of aluminum recycling, allows us to remove any creation of waste and environmental risks.



FOR MORE INFORMATION
VISIT OUR WEB
www.cortizo.com



Sistema / System

› COR VISION

SISTEMAS DE ALUMINIO Y PVC PARA LA ARQUITECTURA
ARCHITECTURAL ALUMINIUM AND PVC SYSTEMS

Sistema / System
COR VISION



CERRAMIENTOS CONTEMPORÁNEOS
CONTEMPORARY ENCLOSURES





Muestra ensayada por / Sample tested by
ALUMINIOS CORTIZO S.A.U.



Transmitancia / Transmittance

$U_w \geq 1,3$ (W/m²K)

Consultar tipología, dimensión y vidrio.
Consult typology, dimensions and glass.

CTE - Apto para zonas climáticas*: α A B C D E

*En función de la transmitancia del vidrio.

Aislamiento acústico / Accoustic insulation

Máximo acristalamiento
Maximum glazing **30 mm**

Máximo aislamiento acústico
Maximum accoustic insulation **Rw = 41 dB**

Secciones Sections

Espesor perfilera Profile thickness

Marco / Frame	116 mm	Puerta / Door	1,7 mm
	182 mm tricarril		
Hoja / Sash	37 mm		

Longitud varilla poliamida
Polyamide strip length **16 - 24 mm**

Categorías alcanzadas en banco de ensayos Categories achieved at test centre

Permeabilidad al aire / Air permeability
(UNE-EN 12207:2000): **Clase / Class 4**

Estanqueidad al agua / Water tightness
(UNE-EN 12208:2000): **Clase / Class 7A**

Resistencia al viento / Wind resistance
(UNE-EN 12210:2000): **Clase / Class C5**

Ensayo de referencia ventana 1,23 x 1,48 m, 1 hoja + 1 fijo.
Reference test 1,23 x 1,48 m, 1 sash + 1 fixed light.

Acabados / Finishes

Posibilidad bicolor / Possibility of dual colour
Lacado colores (RAL, moteados y rugosos) / Colour powder coating (RAL, mottled & rough)
Lacado imitación madera / Wood effect powder coating
Lacado antibacteriano / Anti-bacterial powder coating
Anodizado / Anodized

Posibilidades de apertura Opening possibilities

Corredera de 1, 2, 3, 4 y 6 hojas
Posibilidad monocarril, bicarril y tricarril
Posibilidad de apertura en esquina y rincón a 90° sin parteluz
Posibilidad galandage de 1, 2, 3 y 4 hojas

Sliding of 1, 2, 3, 4 & 6 sashes
Possibility of 1, 2 or 3 rails
Possibility of interior and exterior corner sash at 90° without mullion
Galandage possibility in 1, 2, 3 & 4 sashes.

Dimensiones máximas/hoja Maximum dimensions/sash

Ancho / Width (L) = 2500 mm

Alto / Height (H) = 3000 mm

Consultar peso y dimensiones máximas según tipología.
Consult maximum weight and dimensions in accordance to typology.

Peso máximo/hoja
Maximum weight/sash 320 Kg

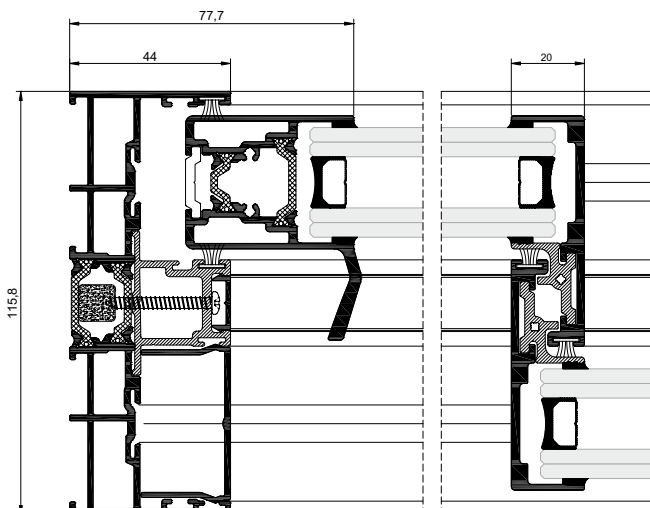

Diego Piñeiro Janeiro
Director de I+D+i / R&D Manager